

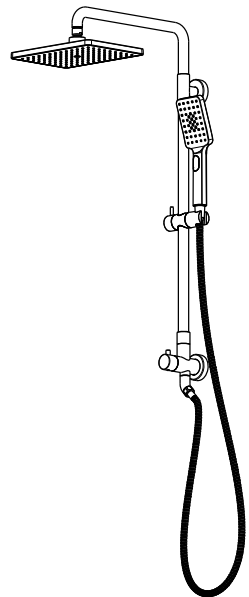

Installation Guide

Shower Column



KSC402

Installation Instructions

 **READ ALL INSTRUCTIONS BEFORE UNPACKING THE PRODUCT** 

Important

- 1- For best results, we recommends that this unit be installed by a licensed, professional plumber.
- 2- Please read over these instructions thoroughly before beginning installation. Make sure that you have all tools and supplies needed to complete the installation.
- 3- Please flush the water system to ensure that no metal swarf, solder, and other impurities can enter the faucet that might damage the cartirdge. (Most of the leakages and water flow issues are from avoinding this very necessary step).
- 4- Turn off the hot and cold water lines at the angle valve and turn on the old faucet to release any built-up pressure.
- 5- Keep this booklet and the receipt (or other proof of date and place of purchase) for this product in a safe place.
The receipt is required should it be necessary to request warranty parts.
- 6- Please keep the box and packaging materials until your product is completely installed and functional.
- 7- Do not return to store if problems, Contact Customer Service ASAP at 855-883-0888 or email support@kibiusa.com to get help.

Tools you may need



1. Drill



2. Pencil

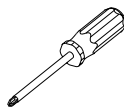

3. Phillips Screwdriver

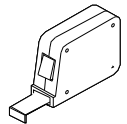

4. Tape Measure

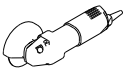

5. Angle Grinder

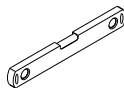

6. Level

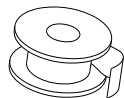

7. Plumbers Tape

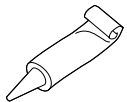

8. Silicone sealant

1

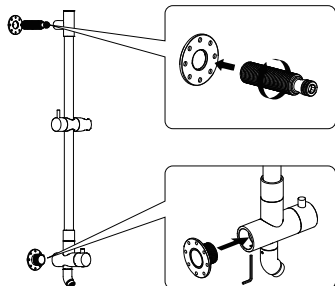

Hand tighten upper mounting flange onto inlet fitting.
Insert the lower mounting post into the lower post of the shower column, tighten hex screw with hex wrench supplied.

Note: Shut off water suppliers.

2

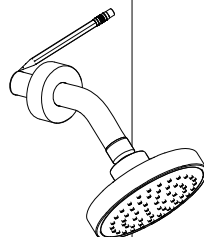

Place mark on existing shower arm at wall surface.

3

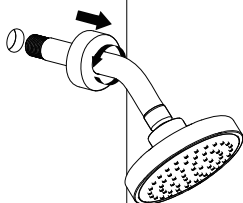

Unscrew shower arm from elbow in wall.

4

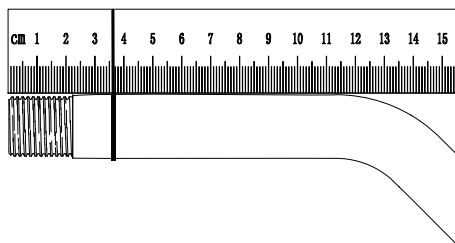

Measure distance from mark on shower arm to end of the shower arm threads.

5

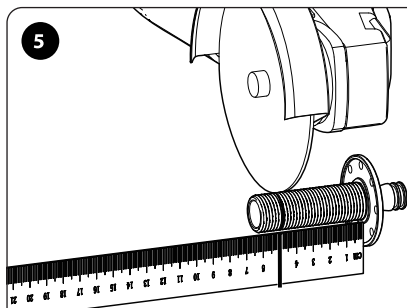

Cut off the excess.

Note: If measurement is between 2-5/16" - 2-5/8" (58-66mm), it does not need to be cut off.

6

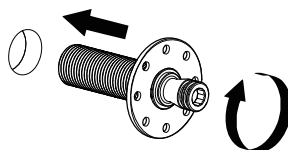

Thread the inlet fitting into the built-in pipe outlet and hand tighten.

Installation

7

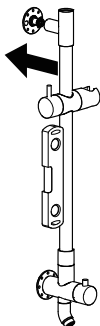

Install the shower column onto the inlet fitting, ensure there is no gap between the shower column and the inlet adapter. Lever the shower column.

8

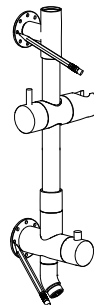

Mark the center slots of the upper mounting flange. Mark the center slots of the lower post and around the lower mounting post.

Note: These are the points where you will drill holes for installing the toggle bolts. Ensure that there are not plumbing, electrical or other obstructions are contained behind the wall in these locations.

9

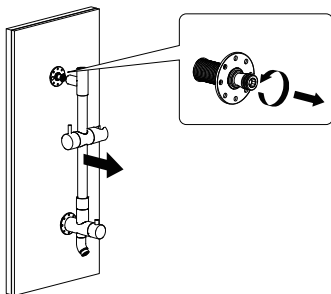

Remove the shower column and inlet fitting.

10

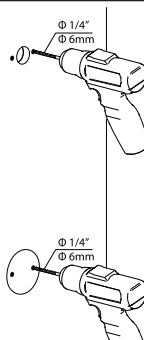

Drill 1/4"(6mm) holes at the mark positions.

Note: Kibi suggested to drill holes for lower mounting post installation, But if drilling holes may broken the pipes inside, the 3M sticker in the package are suggested to use.

11

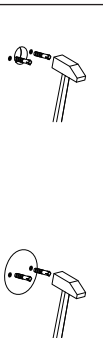

Insert anchors.

Note: Kibi suggested to drill holes for lower mounting post installation, But if drilling holes may broken the pipes inside, the 3M sticker in the package are suggested to use.

12

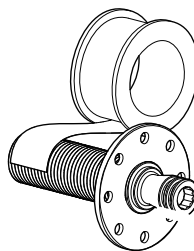

Apply plumbers tape to threaded end on the inlet fitting.

13

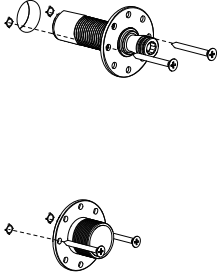

Thread the inlet fitting into the built-in pipe outlet and tighten using a smooth jawed wrench.

Assemble set screws into the mounting flange and tighten.

Note: Kibi suggested to drill holes for lower mounting post installation, But if drilling holes may broken the pipes inside, the 3M sticker in the package are suggested to use.

14

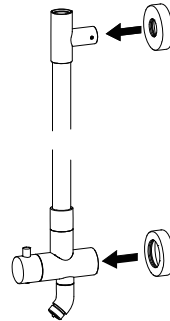

Assemble the upper escutcheon and lower escutcheon onto the upper and lower post of the shower column, respectively.

15

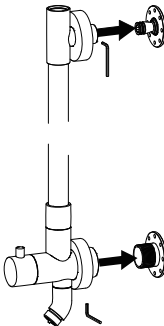

Install the shower column onto the inlet fitting and lower mounting post. Then use the hexagonal wrench to tighten the hexagonal socket screw set.

16

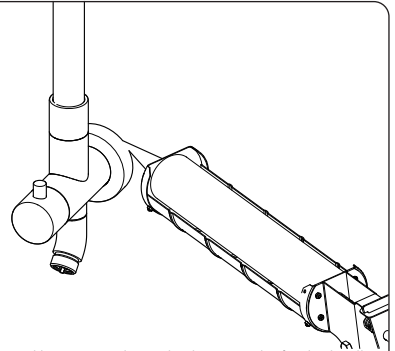

Slide the upper and lower escutcheons back against the finished wall. Apply silicone sealant to the rear lip of the upper and lower escutcheons.

17

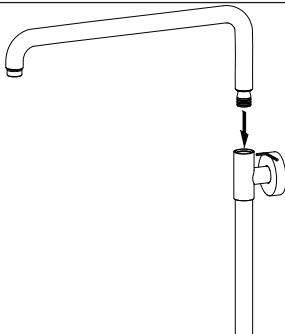

Assemble the overhead shower arm into the shower column. Ensure it is fully seated. Install 1 of the set screws into the shower column and tighten.

18

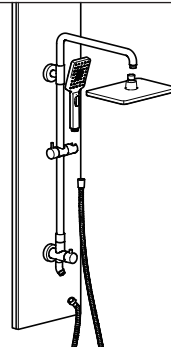

Install shower head, hand shower and hose. Turn on the main water valve.

Note: Check for leak.

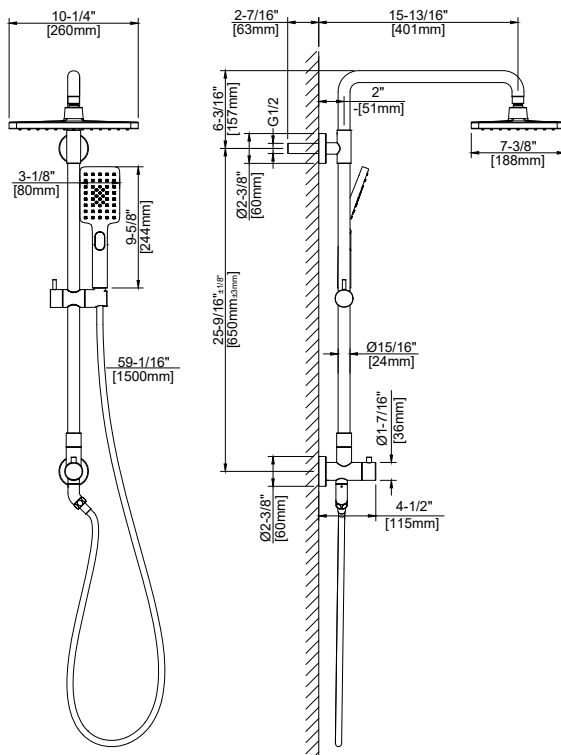

Clean the faucet often with a soft cloth to keep it looking like new. For heavy cleaning you can use mild liquid detergents or non-abrasive liquid polisher. Rinse with water and dry with a soft cloth. Avoid abrasive cleaners, steel wool and harsh chemicals as these will dull the finish and void your warranty.

LIMITED LIFETIME WARRANTY

KIBI provides its customers with an extensive warranty as a result of our excellent workmanship and high quality components used in our products.

Mechanical warranty: A limited lifetime warranty is provided on all mechanical parts to be free from manufacturing defects in materials and workmanship under normal use for as long as the original purchaser owns their home.

Finish warranty: A 5-year warranty is provided on all KIBI faucet finishes to the original purchaser against manufacturing defects in materials and workmanship.

At its sole discretion, KIBI will repair or replace any part or finish that proves to be defective in material and/or workmanship under normal installation, use and service.

This warranty is extended to the original consumer owner, but does not cover installation or any other labor charges. In no event shall KIBI be liable for any incidental, consequential or special damages, installation cost, labor, travel time, freight costs incurred, lost profits, or contingent liabilities. KIBI makes no representation that its products comply with any or all local building or plumbing codes. It is the consumer's responsibility to determine local code compliance.