

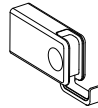

# Installation Guide



**Artis  
KBA1001**



**Artis  
KBA1003**

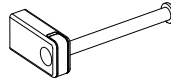

**Artis  
KBA1002**

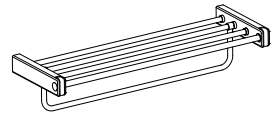

**Artis  
KBA1004**

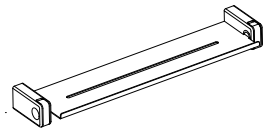

**Artis  
KBA1005**

## Installation Considerations

These products should be located and mounted to a wall stud. While it is possible to mount them to any surface, a stud mounted product will yield the best results.

Keep this booklet and the receipt (or other proof of date and place of purchase) for this product in a safe place. The receipt is required should it be necessary to request warranty parts.

**Please keep the box and packaging materials until your product is completely installed.**

## SAFETY TIPS

### ⚠ **WARNING!**

This item is not designed for use as a grab bar. Do not mount in locations where product is likely to be used as a grab bar.

### ⚠ **WARNING!**

Use caution when drilling into walls to avoid drilling into electrical and plumbing lines hidden within wall.

## Tools you may need

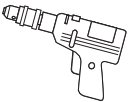

Electric drill

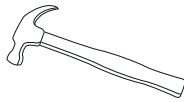

Hammer

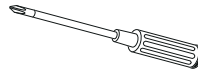

Phillips screwdriver



Pencil

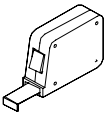

Tape measure

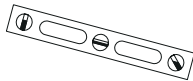

Level

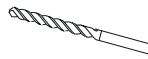

1/8 in. drill bit  
1/4 in. drill bit  
5/16 in. drill bit

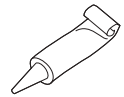

Silicone sealant

### 1 For all installations

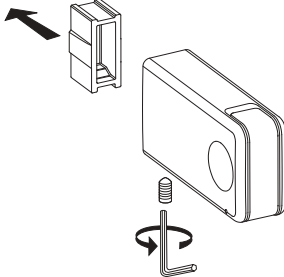

Loosen the set screw and remove the mounting plate from the accessory.

### 2 Single-Post accessories

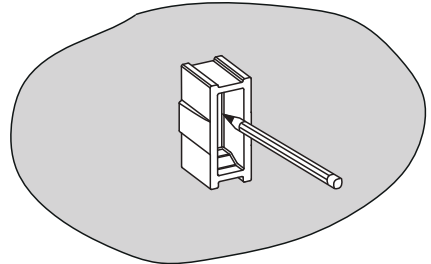

Using the mounting piece as a template, mark the positions of the screw holes.

### 3 Two-post accessories

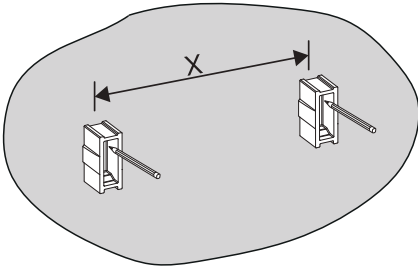

Using the mounting piece as the (X), Confirm lever, mark the positions of the screw holes, Verify "X" against the measurements of your product model.

### 4 For Ceramic Tile

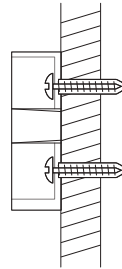

Drill 1/4" pilot holes and insert the plastic anchors into drilled holes using a hammer to tap the anchors flush with wall. Secure the mounting plate(s).

### 5 For drywall into Studs

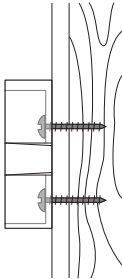

Drill 1/8" holes, secure the wall plate(s).

### 6 For drywall Between Studs

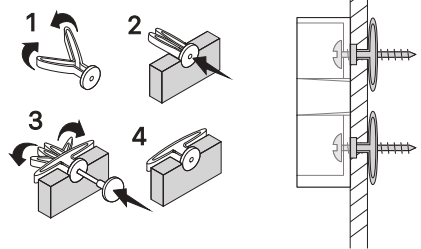

Drill 5/16" holes, Use the anchors to secure the mounting plate(s).

**Note: Anchors is not provided.**

### 7 For single-post Accessories

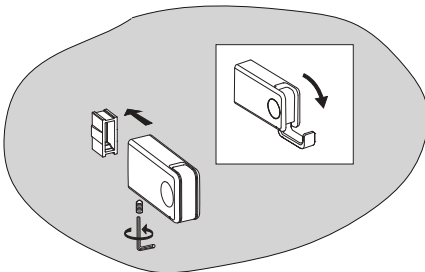

Slide the accessory onto the mounting plate, tighten the set screw.

### 8 For two-post Accessories

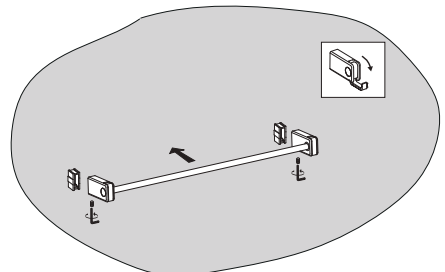

Slide the accessory onto the mounting plates, tighten the set screws.

---

**Cleaning Instructions:**

To maintain and protect the fine luster of all bath accessories, clean with a soft, damp cloth only. DO NOT USE scrub pads, detergents or cleansers as they may harm the protective finish of your bath accessories.

Damage to the product caused by improper care or the use of improper cleaning agents is not covered by the warranty.

**Warranty:**

Warranted to be free from manufacturing defects for a period of one (1) year from the date of purchase.



[www.kibiusa.com](http://www.kibiusa.com)